

## SCREW HOLE CHART

COUNTER SUNK SCREW HOLES FOR A FLUSH APPEARANCE. NO. 6 x 1 1/2" OVAL HEAD SCREWS ARE PLATED OR PAINTED TO MATCH THE PRODUCT FINISH AND FURNISHED WITH ALL UNITS REQUIRING MOUNTING HOLES.

ALL SIZES ARE LIST SIZES.

\* WHEN FRAMES ONLY REQUIRE 1 HOLE, THE HOLE WILL BE CENTERED WHEN FRAMES ARE > 48", MOUNTING HOLES N.T.E. 18" O-C

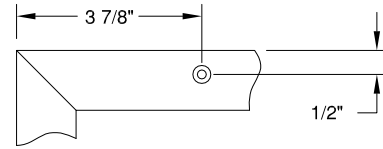

MOUNTING HOLE DETAIL

	4 AND LESS THAN 18	18 AND LESS THAN 30	30 AND LESS THAN 48	48
4 < 18	LONG DIMENSION • 2 SCREWS •  10 < 18 LONG DIMENSION • 4 SCREWS •	LONG DIMENSION  4 SCREWS	LONG DIMENSION  6 SCREWS	LONG DIMENSION  8 SCREWS
18 < 22	LONG DIMENSION 4 SCREWS	LONG DIMENSION  6 SCREWS	LONG DIMENSION  8 SCREWS	LONG DIMENSION  10 SCREWS
22 < 30	LONG DIMENSION 4 SCREWS	LONG DIMENSION  8 SCREWS	LONG DIMENSION  10 SCREWS	LONG DIMENSION  12 SCREWS
30 < 48	LONG DIMENSION 6 SCREWS	LONG DIMENSION  10 SCREWS	LONG DIMENSION  12 SCREWS	LONG DIMENSION  14 SCREWS
48	LONG DIMENSION 8 SCREWS	LONG DIMENSION  12 SCREWS	LONG DIMENSION  14 SCREWS	LONG DIMENSION  16 SCREWS

DWG NO.

02HV193D

JOB NAME: \_\_\_\_\_

ENGINEER: \_\_\_\_\_

DATE:

6/25/07

LOCATION: \_\_\_\_\_

CONTRACTOR: \_\_\_\_\_

ARCHITECT: \_\_\_\_\_

FINISH: \_\_\_\_\_